

# Technical Data Sheet

## Fresh TL80FdBS Acoustic Wall Vent

### Product

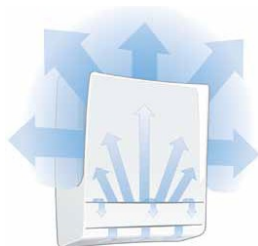
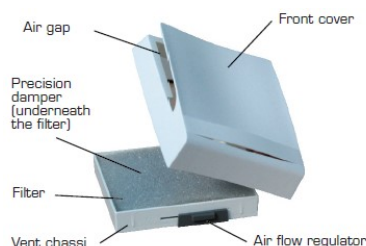

### INSTALLATION

- Place vent as high as possible at least 10cm below ceiling, preferably above radiator
- Check for services before drilling
- Use core drill with minimum dim  $\varnothing$  125mm for TL80FdBS and  $\varnothing$  140mm for TL80FdB
- Drill hole so pipe slopes slightly downwards
- If wall thickness is less than 300mm pipe can be cut to required length, if over additional pipes may be required
- Seal pipe both inside and outside with a suitable sealant agent
- Mechanically fix external grille into place. In areas of high exposure replace external grille with Tyfon grille or storm cover.
- Remove internal vent housing and mechanically fix with 4 screws. Set the required opening with the control.
- Attached front cover and check vent is fully operational
- Wash filter 1-2 times per year with mild soap solution.

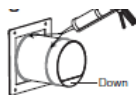

### FEATURES & BENEFITS

- Sound reduction model with acoustic sleeve.
- Designer shaped wall vent for continuous draught free and filtered airflow
- Supplied with standard dust and insect filter
- Front cover insulated from condensation and sound penetration
- Unique air distribution pattern
- Precision damper is adjustable by a regulator with a 1-10 scale located behind the front cover.
- Easy to clean and install
- Wide range of storm and Allergy filter accessories available
- Locate vent high on the wall above radiators.
- Designed to work with underfloor heating.

### Product Details

<b>Free Area</b>	4000mm <sup>2</sup>
<b>Wall opening</b>	TL80FdBS - 124mm diameter
<b>Maximum thickness</b>	TL80dB - 400mm TL80dBS—400mm
<b>Size</b>	Internal grille - 156x168x46mm
<b>Sound Reduction</b>	TL80FdBS — 46dB TL80FdB — 49dB

Measurement TL80F-dBS

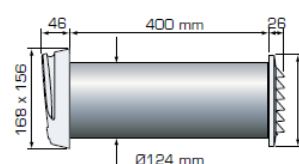

Measurement TL80F-dB, TL98F-dB

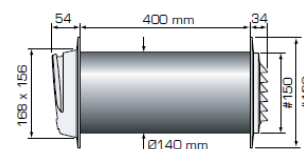

<b>Colour</b>	White RAL9010
<b>Code</b>	TL80FdBS (acoustic)

