

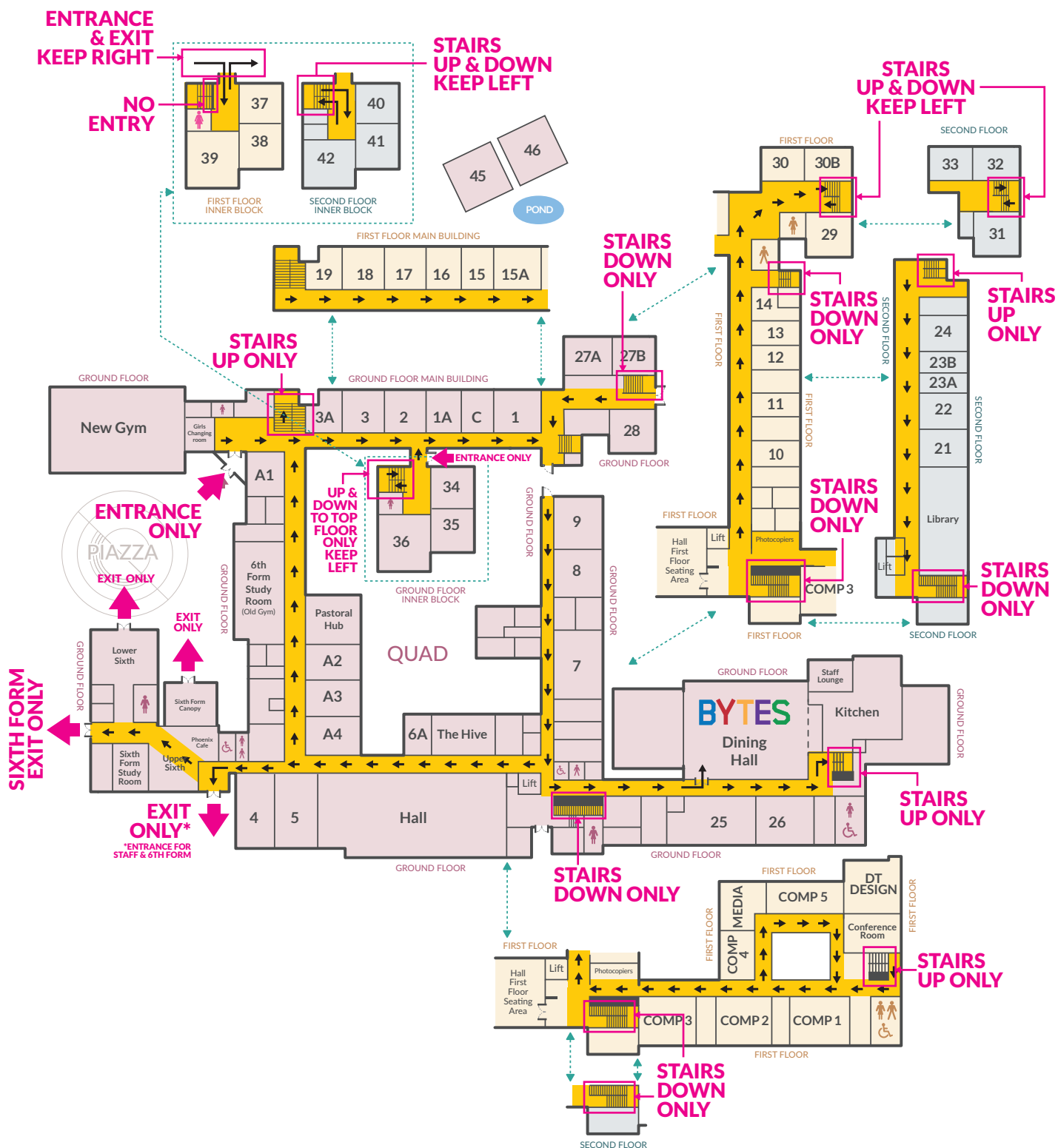

**TOWNLEY**  
EST 1937  
GRAMMAR SCHOOL

# ONE-WAY SYSTEM



## Important Update: Introduction of a One-Way System in the Main School Building

We are writing to inform you of an important and necessary change that will be implemented in the main school building from January 2026. In order to improve the flow of movement, ease congestion in our corridors and enhance overall student safety, we will be introducing a one-way system throughout the main school building. This decision has been made in line with our ongoing commitment to Health and Safety requirements.